

# Model VK0.5M: Specifications

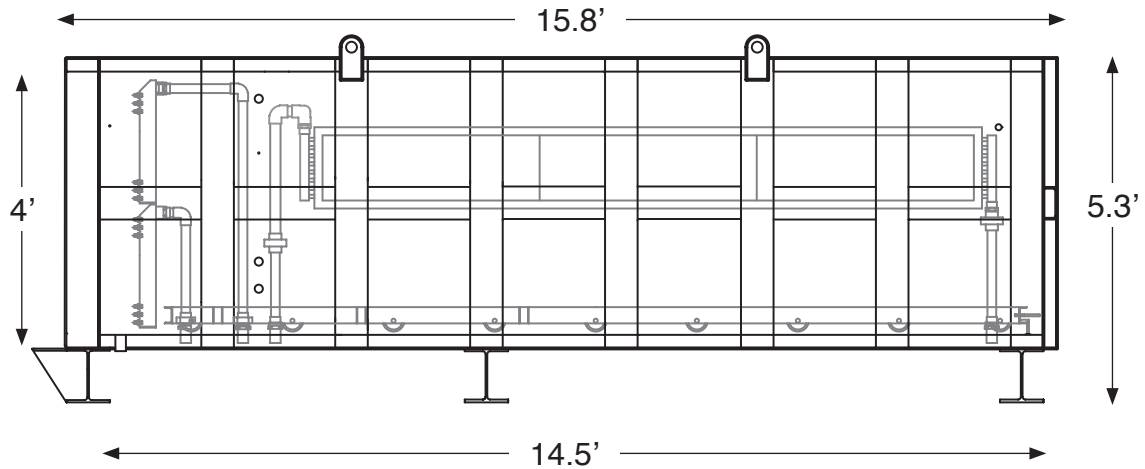

| Specifications                     |             |
|------------------------------------|-------------|
| Interior Width                     | 4'          |
| Interior Height                    | 4'          |
| Interior Length                    | 14.5'       |
| Clear Plate Length                 | 13'         |
| Plate Width                        | 40"         |
| Exterior Width                     | 4.5'        |
| Exterior Height                    | 5.3'        |
| Exterior Length                    | 15.8'       |
| Ext. Length (Incl.Rails and Winch) | 33.5'       |
| Shipping Weight                    | 9,650 lbs   |
| Combined Service Entrance          | 460V 20A    |
| Boiler Input Requirement           | 30,000 BTUs |
| Minimum Cooling Requirement        | 6 Tons      |
| Number of Plates                   | 7           |

| Projections                    |            |
|--------------------------------|------------|
| BFT per layer (12' Length 8/4) | 86.7       |
| Layers per Load                | 6          |
| Total BFT per Load             | 520.2      |
| Drying Time (Hard Maple)       | 6 Days     |
| Loads per Month                | 5          |
| Total BFT per Month            | 2,601      |
| Total BFT per Year             | 31,212     |
| Electrical Usage per Load (\$) | \$15.94    |
| Electrical Usage per Year      | \$1,147.68 |
| Cost of Electricity per BFT    | \$0.04     |

| Energy Requirements          |             |
|------------------------------|-------------|
| Electricity per Load         | 261.3 kW    |
| Cost of kW per Load          | \$15.94     |
| BTU per Load                 | 2,763,716   |
| Avg. BTU/Hour                | 38,385      |
| Vacuum Pump Elec. Usage      | 460V / 7.6A |
| Hot Water Pump Usage         | 460V / 1.4A |
| CT Pump Usage                | 115V / 2.5A |
| Water Circulation Pump Usage | 115V / 4.5A |
| CT Fan Motor Usage           | 230V / 2.2A |

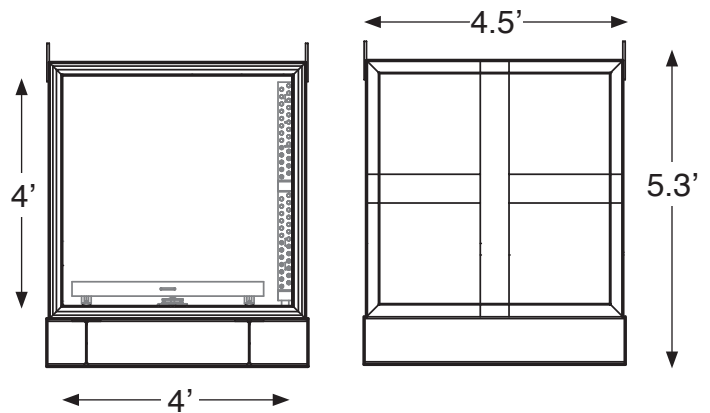

**Note:** Projections and Energy Requirements based on drying Hard Maple.